

*Accentuate*  
**YOUR CONSCIENCE &  
SOAK IN ROYALTY**

INTRODUCING  
SHOWER MAX EQUIPPED WITH  
**5-7 WAY THERMOSTATIC  
DIVERTER**

FOR A SOULFUL BATHING  
EXPERIENCE





*Rejoice in the*  
**RAINSHOWER**

---

Maximize your shower experience  
with Shower Max Rain Mode  
that lets you rejoice in the  
drizzling rainshower







*Experience  
the Cascading  
WATERFALL*

---

Encapsulate yourself in a mystical waterfall. Let the water gently pour over you in Shower Max Waterfall Mode.





*Immerse into an  
Exhilarating*  
**SHOWER  
EXPERIENCE**

---

Shower Max gives  
you ample choice to reinvent  
your shower experience  
with 5-7 Way Diverter



### FEATURES

- Concealed 5-7 way 4 knob - Thermostatic diverter 3/4" inlet & 3/4" outlet for high volume of water.
- 7 Outlet operated through three Knobs.
- Can operate three functions together.
- Vernet thermostatic Cartridge.
- Completely covered concealed body.
- Inbuilt water leveler to check horizontal as well as vertical alignment of concealed body.
- 26 mm of margin for minimum & maximum level of putting tile / marble.

1 - RAIN | 2 - CASCADE | 3 - MIST

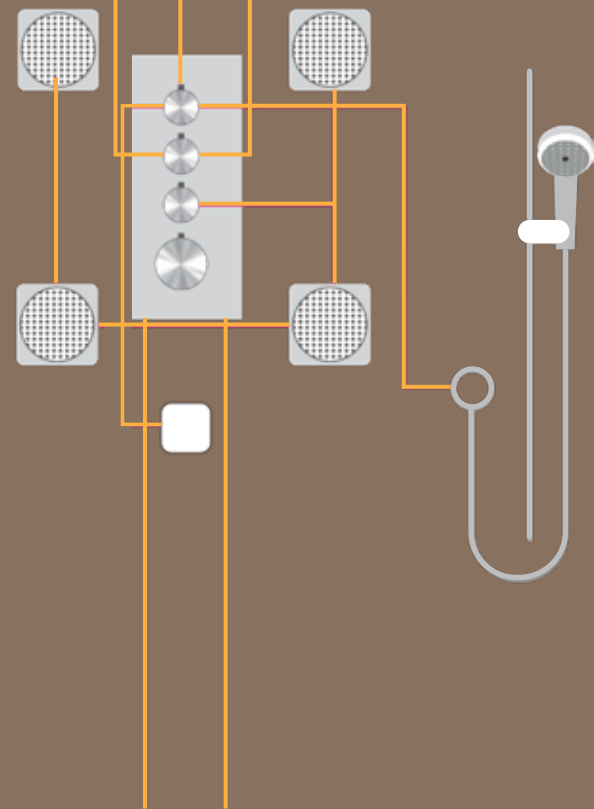
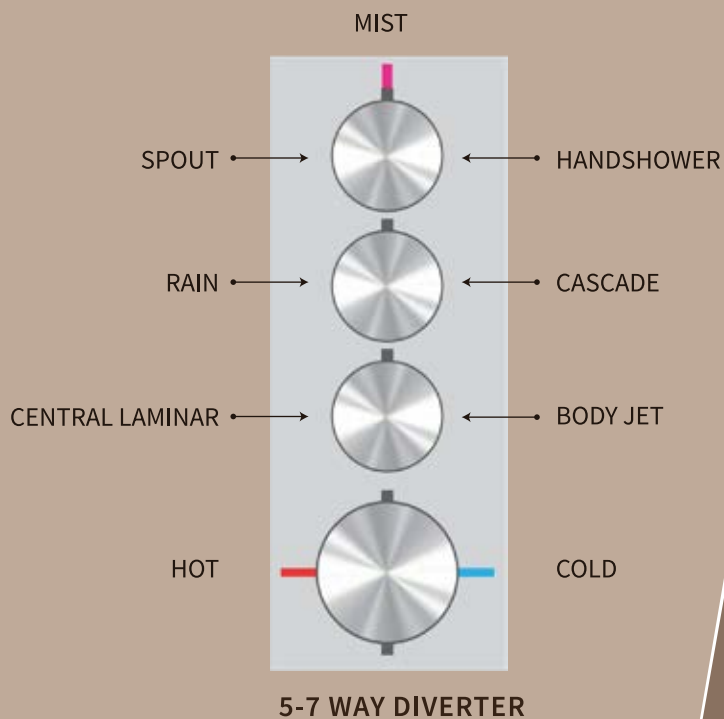
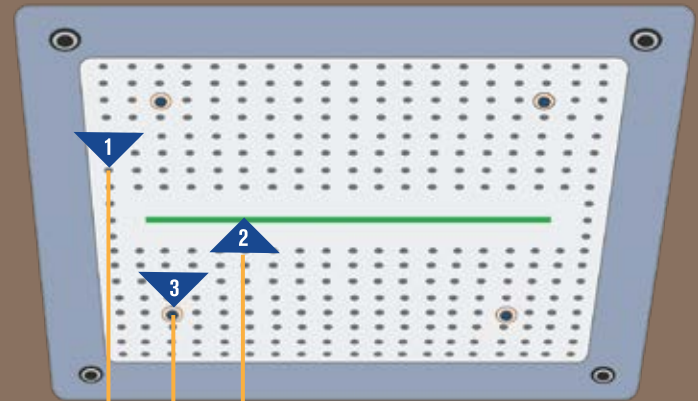



## USP

- 20 mm Inlet / Outlet for high volume of water
- 26 mm of margin for minimum & maximum level of placing life / marble
- Inbuilt water leveler to check horizontal as well as vertical alignment of concealed body

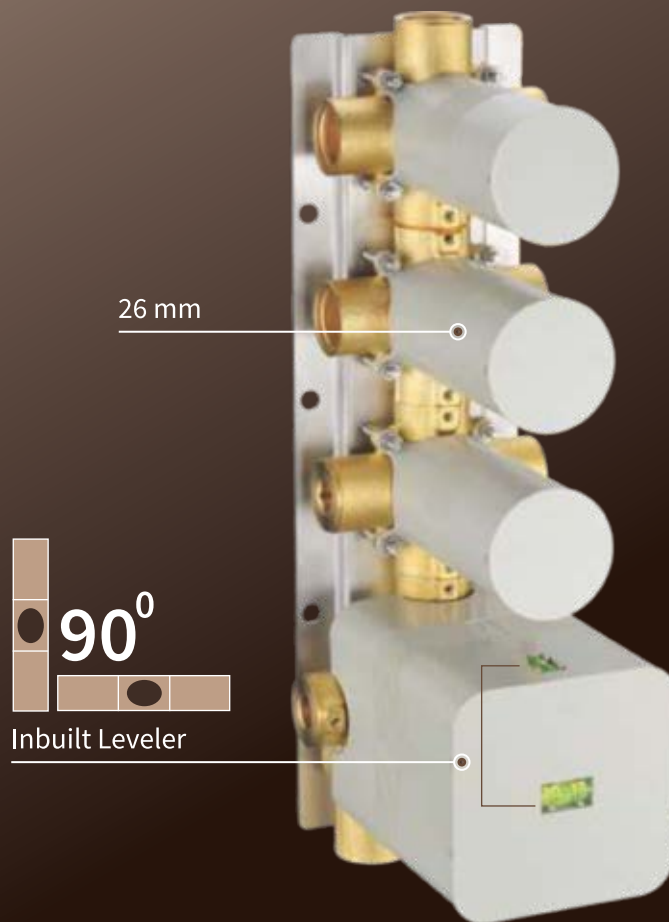

## TECHNICAL DRAWING

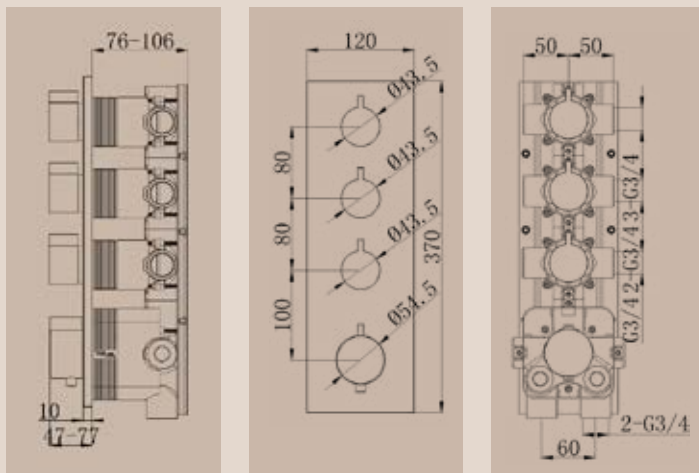

Operating pressure: max. 1 Mpa

Hot water temperature: max. 70° C

Recommended operating pressure: 0.0-0.5 Mpa

Recommended hot water temperature 65° C

Test pressure: 1.6 Mpa

Thermal disinfection: max. 70° C / 4 min.

1 Mpa = 10 bar = 145 PSI

Safety against backflow integrated

3 Function Knob

2 Function Knob

2 Function Knob

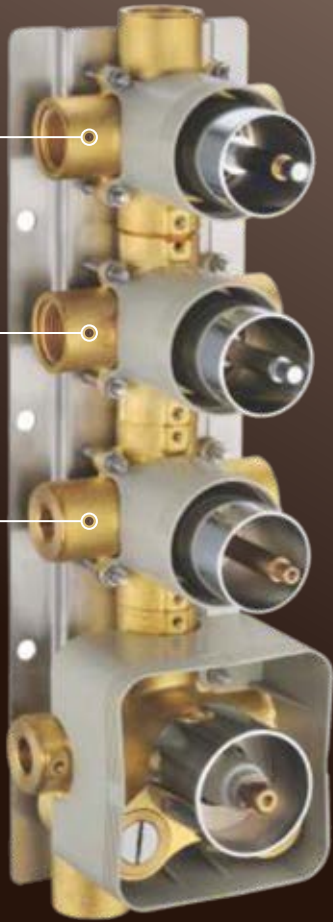

## ADVANTAGE

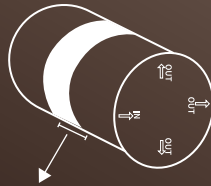

26 mm of margin for minimum & maximum level of placing tile / marbles

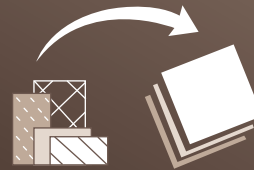

Even at a later stage customer can shift from tiles to stone



Inbuilt water leveler to check horizontal as well as vertical alignment of concealed body

- ◆ 1 - FUNCTION KNOB
- 2 - FUNCTION KNOB
- 3 - FUNCTION KNOB

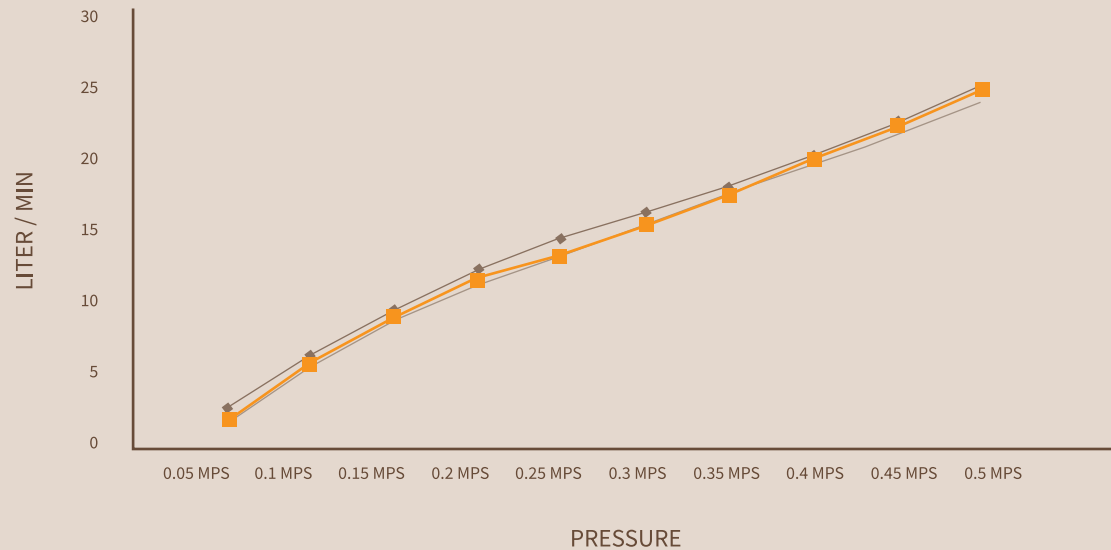

## BUILT-IN THERMOSTATIC SHOWER MIXER

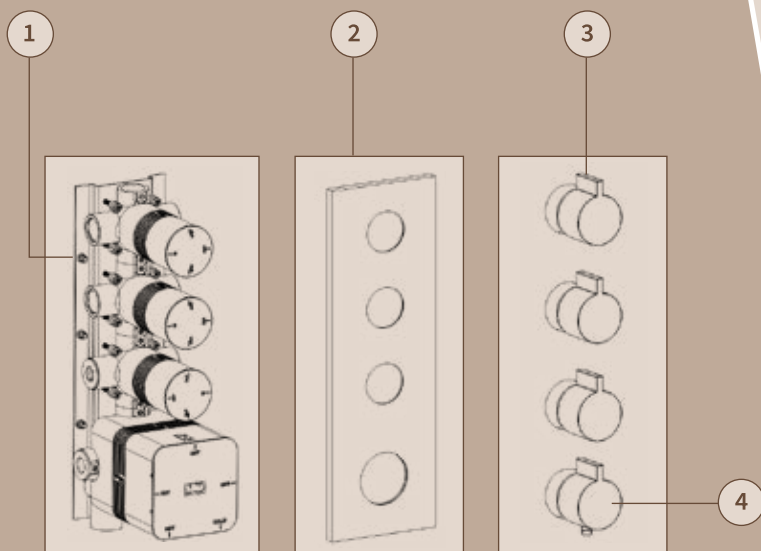

## TECHNICAL DATA

Ref.	Description	Quantity
1.	Main mixer unit	1
2.	Decorative cover plate	1
3.	Diverter knob	3
4.	Thermostatic mixer knob	1

## RECOMMENDATIONS

1. All necessary protective equipments should be used prior to and whilst undertaking any installation steps
2. This product is intended for bathing, hygienic and personal cleaning purposes
3. The hot and cold supplies must be of equal pressure

## TOOLS RECOMMENDED FOR INSTALLATION



PTFE /  
Teflon Tape



Allen (Hex)  
key set



Marker



Knife or Saw



Wrench



Measuring Tape



Screw Driver



Thermometer



Safety  
Equipment

## DISCLAIMER

1. The pipes and fixture must be installed, flushed and tested as per the applicable standards.
2. Safety function - the desired maximum temperature can be set above 38° C via the safety function.



# INSTALLATION

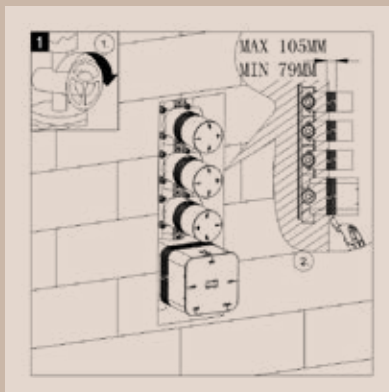

Prior to installation, ensure that the hot and cold water supplies are both shut off.

The recess should be made, such as to have the mixer protrude out of the surface at the indicated markings (79mm minimum and 105mm maximum).

Use the provided spirit level indicators to level the unit. Connect the water supplies and outlets securely.

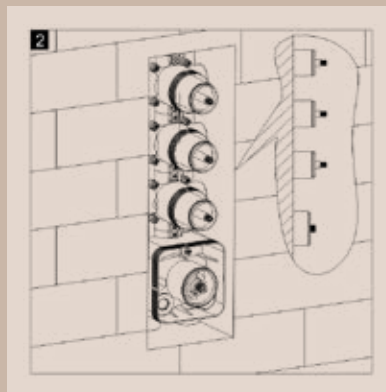

The excess plastic should be removed, and no plastic covering should protrude out of the surface.

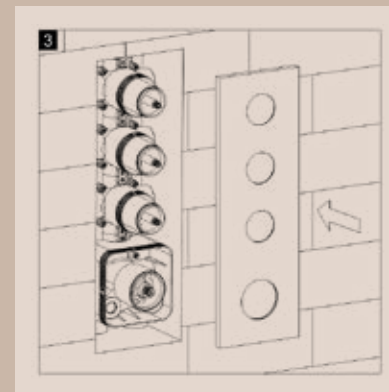

Once all connections are properly fitted, install the decorative cover plate.

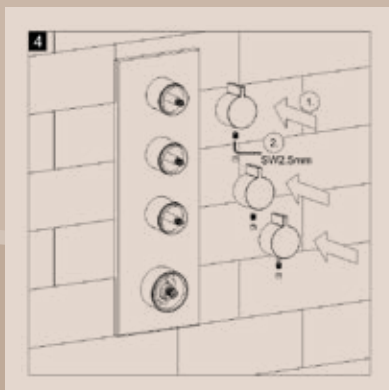

Install the diverter knob into position and secure it in place via the provided grub screw. Clip on the decorative grub screw cover.



Open water supply for hot and cold pipelines. With the thermostatic mixer set at 38°C, set the diverter for direct water to the hand shower and check the temperature with a thermometer which should correspond to the 38°C setting (refer to the Calibration section if the temperature reading is different).

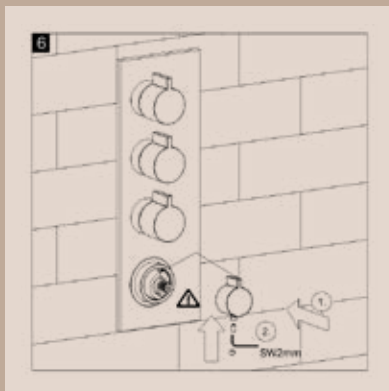

Install the thermostatic mixer knob into position and secure it in place via grub screw. Clip on the decorative grub screw cover.

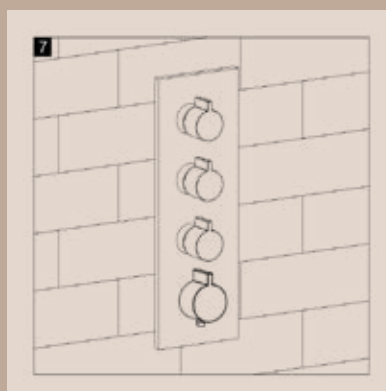

The installation is complete.

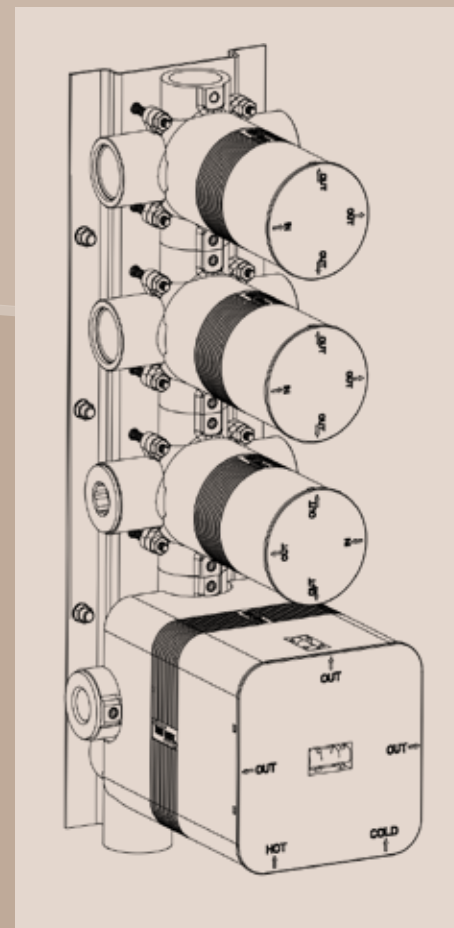

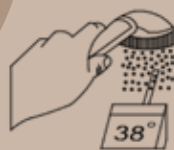

## CALIBRATION

After the installation, the output temperature of the thermostat must be checked. A recalibration correction would be necessary if the temperature measured at the output differs from the temperature set at the thermostat. The below steps should be followed to perform thermostat calibration.

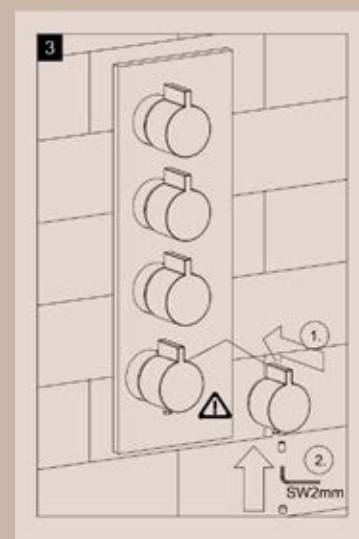
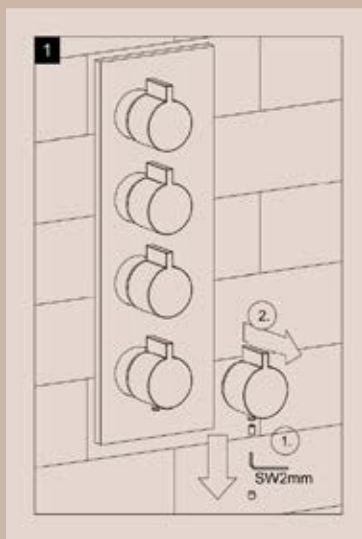

MAX. # 38°C

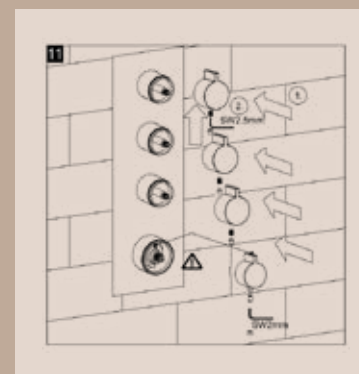
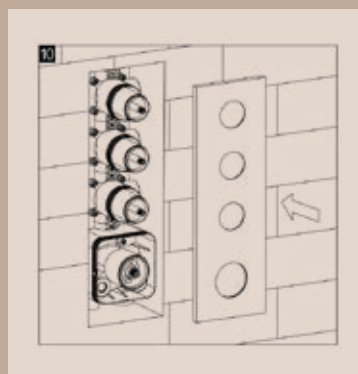
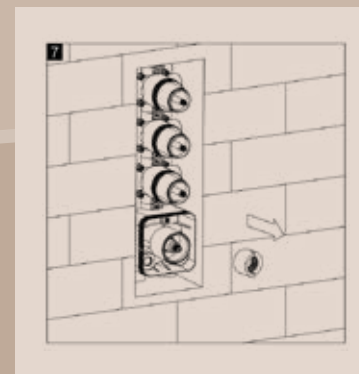
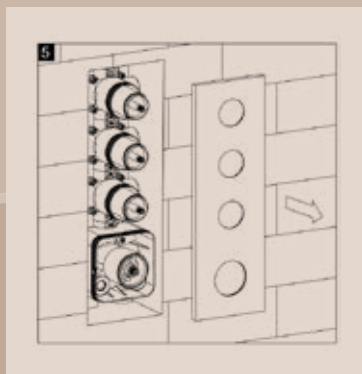



# MAINTENANCE

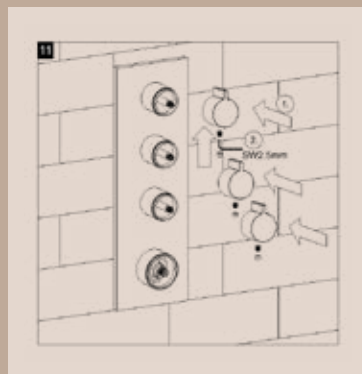
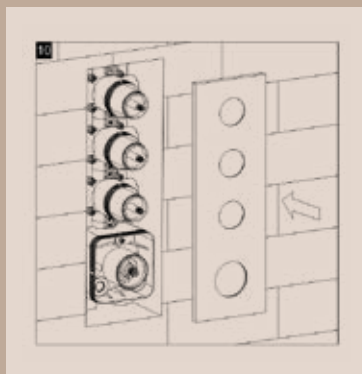
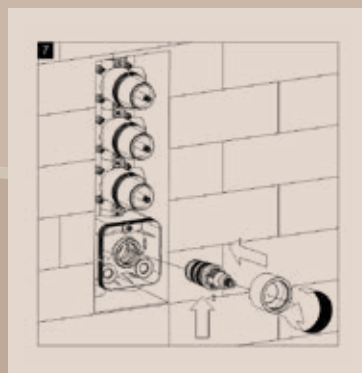
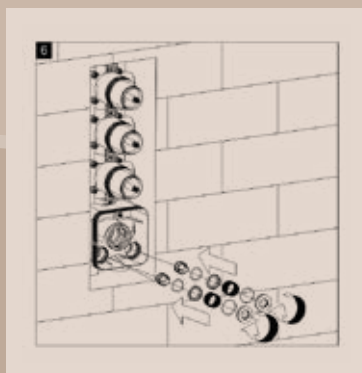
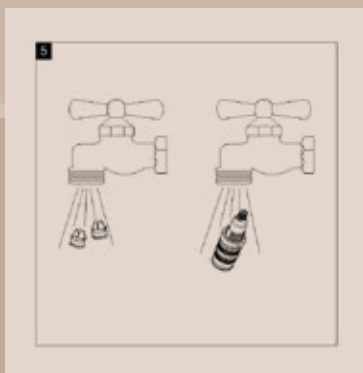
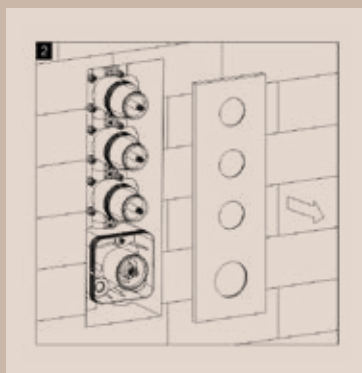
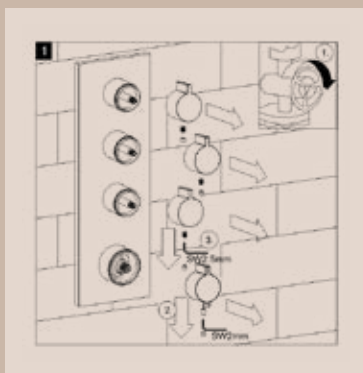





## Oyster Bath Concepts Pvt. Ltd.

**Corporate Office:** D-73, Okhla Industrial Area, Phase - 1, New Delhi - 110020  
Tel: 011-45729000 | Email: [info@oysterbath.com](mailto:info@oysterbath.com), [sales@oysterbath.com](mailto:sales@oysterbath.com)

---

### **Regional Office:**

**Bangalore:** 499 East End Main Road, 9th Block, East Jayanagar, Bangalore - 560069  
Tel: 080-26645448, 26645447 | Mob: +91 8884421000 | Email: [bangalore@oysterbath.com](mailto:bangalore@oysterbath.com)

---

**Kolkata:** AA-47, 2nd Floor, Salt Lake, Kolkata - 700164  
Mob: +91 8697980112 | Email: [kolkata@oysterbath.com](mailto:kolkata@oysterbath.com)

---

**Mumbai:** 31-F Laxmi Industrial Estate, Road No. 1, Off Link Road, Andheri West, Mumbai - 400053  
Mob: +91 9350597704, +91 8879088901, +91 8879088905 | Email: [mumbaicare@oysterbath.com](mailto:mumbaicare@oysterbath.com)

---

**Manufacturing Unit:** B-19 & 20, UPSIDC, M.G. Road, Industrial Area, Ghaziabad - 201313, Uttar Pradesh

---

**Toll Free No: 1800-102-8999 | CIN No: U74899DL1993PTC052202**